

# Accessibly App User Guide For Magento

Thank you for choosing Accessibly App for your Magento site. You will find all the necessary details regarding the installation process in this document.

## Set-Up

Once you log into your site's Magento dashboard, please head over to Stores → Configuration. Here, you will be presented with a view where an API key from the Accessibly Standalone app must be added:

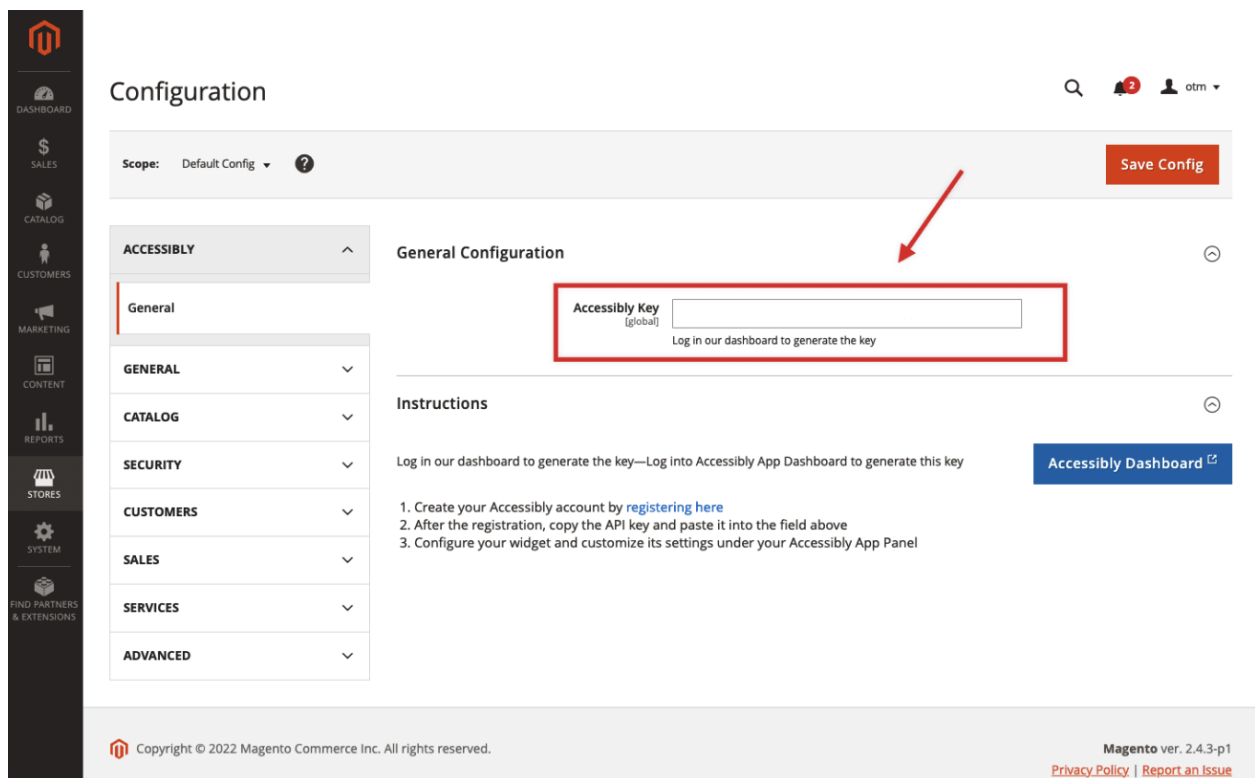

The screenshot displays the Magento Configuration interface. On the left is a vertical sidebar with navigation icons for Dashboard, Sales, Catalog, Customers, Marketing, Content, Reports, Stores, System, and Find Partners & Extensions. The main content area is titled 'Configuration' and shows the 'ACCESSIBLY' section expanded to 'General Configuration'. A red box highlights the 'Accessibly Key' field, which is currently empty. Below the field is a note: 'Log in our dashboard to generate the key'. A red arrow points from the top right towards the field. To the right of the field is a 'Save Config' button. Below the field, there is an 'Instructions' section with a blue button labeled 'Accessibly Dashboard'. The instructions list three steps: 1. Create your Accessibly account by registering here, 2. After the registration, copy the API key and paste it into the field above, and 3. Configure your widget and customize its settings under your Accessibly App Panel. At the bottom of the page, there is a footer with the Magento logo, copyright information for 2022, and the version number 'Magento ver. 2.4.3-p1' along with links for 'Privacy Policy' and 'Report an Issue'.

(Image 1)

You can get this API key once the registration process is complete under [Accessibly Standalone Dashboard](#). After registration is complete, you will see your API key under Accessibly Dashboard here:

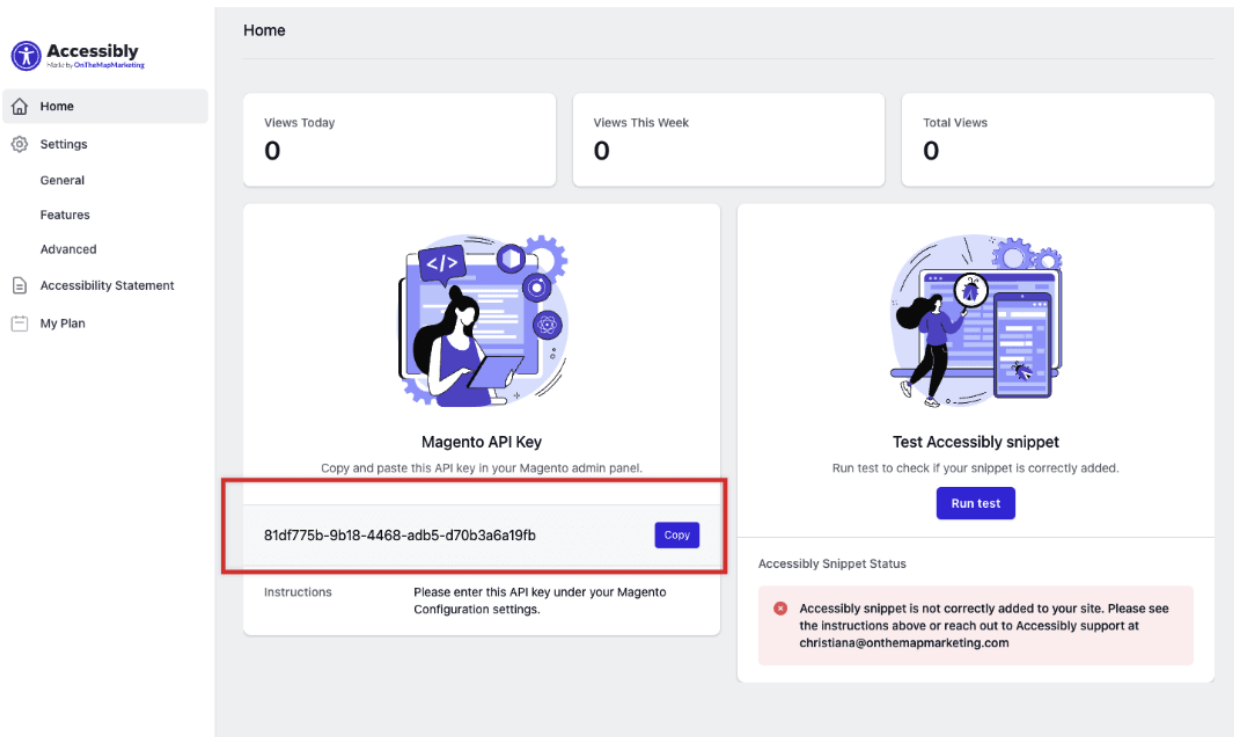

(Image 2)

After you have copied the API, paste it under your Magento Configuration panel(See Image 1) and click “Save”.

## Accessibly App Customization

To update and customize the Accessibly widget, please head over to the standalone version and login. On the sidebar menu, you will see the “Settings” menu. Under here, you can customize everything related to your Accessibly widget.

Make sure that your API is matching under the Store→ Configurations and the one that is provided under your [Accessibly Standalone Dashboard](#).

## Questions?

In case you have any questions regarding Accessibly, feel free to reach out to our team at [hello@accessiblyapp.com](mailto:hello@accessiblyapp.com). We are trying to respond to client inquiries within 1-3 business days.